

NÝTOVACÍ MATICE HLADKÉ





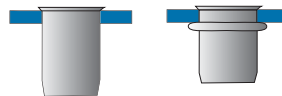
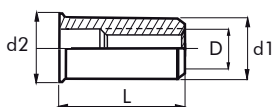

Redukovaná zapuštěná hlava - Otevřená

NEREZOVÁ OCEL



Nerezová ocel A2/304



| D |  MIN. mm MÁX. | L | d1 | d2 |  mm | BALENÍ | |  (N) |  (N) |  (Nm) | Kód zboží |
|------------|---|--------------|-------|-------|---|---|--|--|---|---|------------|
| | | | | | |  vnitřní |  veknovní | | | | |
| M 4 | 0,5 - 2,0 | 11,00 | 5,90 | 7,00 | 6,10 | 500 | 4.000 | 4900 | 10000 | 2,2 | 0303204006 |
| M 5 | 0,5 - 3,0 | 12,00 | 6,90 | 8,00 | 7,10 | 500 | 4.000 | 6000 | 15800 | 3,2 | 0303205007 |
| M 6 | 0,5 - 3,0 | 14,50 | 8,90 | 10,00 | 9,10 | 500 | 3.000 | 9000 | 21600 | 5,8 | 0303206009 |
| M 8 | 0,5 - 3,0 | 16,00 | 10,90 | 12,00 | 11,10 | 250 | 1.500 | 12350 | 36300 | 15,6 | 0303208011 |

NÝTOVACÍ MATICE VROUBKOVANÉ





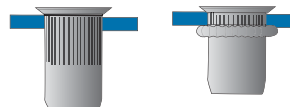
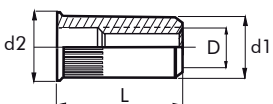

Redukovaná zapuštěná hlava - Otevřená

NEREZOVÁ OCEL



Nerezová ocel A2/304



| D |  MIN. mm MÁX. | L | d1 | d2 |  mm | BALENÍ | |  (N) |  (N) |  (Nm) | Kód zboží |
|-------------|---|--------------|-------|-------|---|---|--|--|---|---|------------|
| | | | | | |  vnitřní |  veknovní | | | | |
| M 3 | 0,25 - 2,0 | 9,75 | 4,90 | 6,00 | 5,10 | 500 | 4.000 | 2700 | 3100 | 2,3 | 0373203005 |
| M 4 | 0,5 - 2,0 | 10,50 | 5,90 | 7,00 | 6,10 | 500 | 4.000 | 4800 | 10300 | 5,5 | 0373204006 |
| M 5 | 0,5 - 3,0 | 12,00 | 6,90 | 8,00 | 7,10 | 500 | 4.000 | 7300 | 14300 | 8,6 | 0373205007 |
| M 6 | 0,5 - 3,0 | 14,50 | 8,90 | 10,00 | 9,10 | 500 | 3.000 | 9600 | 23700 | 14,7 | 0373206009 |
| M 8 | 0,5 - 3,0 | 16,50 | 10,90 | 12,00 | 11,10 | 250 | 1.500 | 11300 | 38600 | 20,0 | 0373208011 |
| M 10 | 1,0 - 3,5 | 19,00 | 12,90 | 14,20 | 13,10 | 150 | 900 | 13400 | >49000 | 27,5 | 0373201013 |