

PEVNOSTNÍ NÝTY HARDLOCK

Plochá hlava

HLINÍK/HLINÍK





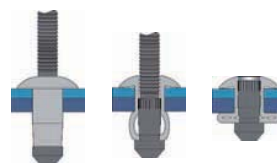
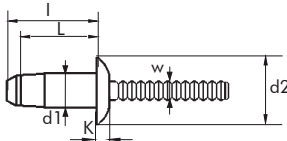

TĚLO: Hliník Al Mg 2,5 (AW5052)

TRN: Hliník



Testováno dle EN ISO 14589

d1 Ø mm	L Nominální mm	 mm	d2 Ø mm	K mm	W Ø mm	BALENÍ		I Max. mm	E mm		 (N)	 (N)	Kód zboží
						 vnitřní	 veknovní		MIN.	MÁX.			
6,4	10,5	6,70-6,90	13,10	2,60	4,20		1.500	15,0	2,8 - 4,8	5000	2800	G1881006410	
	12,5						1.000	17,0	4,8 - 6,8	5200	2800	G1881006412	
	14,5						1.000	19,0	6,8 - 8,8	5400	2800	G1881006414	
	16,5						1.000	21,0	8,8 - 10,8	5400	2800	G1881006416	
	18,5						1.000	23,0	10,8 - 12,8	5400	2800	G1881006418	

PEVNOSTNÍ NÝTY HARDLOCK

Plochá hlava

OCEĽ/OCEĽ





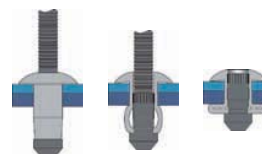
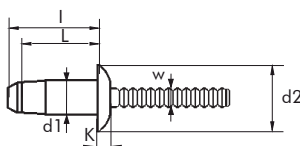

TĚLO: Pozinkovaná ocel A3K

TRN: Pozinkovaná ocel A2K



Testováno dle EN ISO 14589

d1 Ø mm	L Nominální mm	 mm	d2 Ø mm	K mm	W Ø mm	BALENÍ		I Max. mm	E mm		 (N)	 (N)	Kód zboží
						 vnitřní	 veknovní		MIN.	MÁX.			
6,4	10,5	6,70-6,90	13,10	2,60	4,00		1.500	15,0	2,8 - 4,8	12000	8800	G1884006410	
	12,5						1.000	17,0	4,8 - 6,8	12500	8800	G1884006412	
	14,5						1.000	19,0	6,8 - 8,8	14000	8800	G1884006414	
	16,5						1.000	21,0	8,8 - 10,8	15000	8800	G1884006416	
	18,5						1.000	23,0	10,8 - 12,8	16000	8800	G1884006418	
	20,5						1.000	25,0	12,8 - 14,8	16000	8800	G1884006420	
	22,5						1.000	27,0	14,8 - 16,8	16000	8800	G1884006422	

Pozn: Na dotaz umíme nabídnout výrobu nýtu hliník/hliník se zapuštěnou hlavou (d2).