

# SLUPKOVÉ NÝTY

**Vytváří široce rozevřený tvar z druhé strany aplikace (banánová slupka).**

Ideální pro použití v aplikacích s měkkým nebo málo odolným materiálem.

Možno použít pro nadrozměrné otvory.

Rozkládá sílu sevření do široké oblasti

(nedeformuje materiál v aplikaci).



## SEVŘENÍ ROZLOŽENÉ DO ČTYŘ LÍSTKŮ



Trhací nýt z hliníkové slitiny s velkou plochou sevření rozložené do čtyř lístků. Slupkové nýty BRALO jsou ideální pro aplikace s plasty, či materiály s nízkou odolností vůči tlaku.



Slupkové nýty nabízíme v široké škále barevného provedení.

Od černé po bílou, umíme nabídnout přes 100 barev dle vzorníku RAL na základě poptávky.



| d1<br>Ø<br>m/m | L<br>Nominalní<br>m/m | OSTATNÍ BARVY<br>Kód zboží | BALENÍ  |  |
|----------------|-----------------------|----------------------------|---|--|
|                |                       |                            |  vnitřní |  veknovní |
| <b>4,0</b>     | <b>8</b>              | 01130 4008                 | 500   | 4.000  |
|                | <b>10</b>             | 01130 4010                 | 500   | 4.000  |
|                | <b>12</b>             | 01130 4012                 | 500   | 3.000  |
|                | <b>14</b>             | 01130 4014                 | 500   | 3.000  |
|                | <b>16</b>             | 01130 4016                 | 500   | 3.000  |
|                | <b>18</b>             | 01130 4018                 | 500   | 3.000  |
|                | <b>20</b>             | 01130 4020                 | 500   | 3.000  |
|                | <b>25</b>             | 01130 4025                 | 250   | 1.500  |
| <b>4,8</b>     | <b>10</b>             | 01130 4810                 | 500   | 3.000  |
|                | <b>12</b>             | 01130 4812                 | 500   | 3.000  |
|                | <b>14</b>             | 01130 4814                 | 250   | 2.000  |
|                | <b>16</b>             | 01130 4816                 | 250   | 2.000  |
|                | <b>18</b>             | 01130 4818                 | 250   | 1.500  |
|                | <b>21</b>             | 01130 4821                 | 250   | 1.500  |
|                | <b>24</b>             | 01130 4824                 | 200   | 1.200  |
|                | <b>27</b>             | 01130 4827                 | 200   | 1.200  |
|                | <b>30</b>             | 01130 4830                 | 200   | 1.200  |
|                | <b>35</b>             | 01130 4835                 | 150   | 900  |

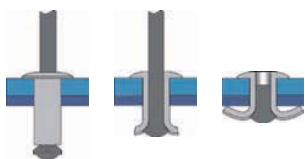



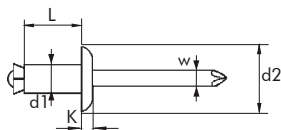

TĚLO: Hliník Al Mg 3,5

TRN: Pozinkovaná ocel A1K

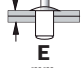

Testováno dle EN ISO 14589

| d1<br>Ø<br>mm | L<br>Nominalní<br>mm | <br>mm | d2<br>Ø<br>mm | K<br>mm | W<br>Ø<br>mm | BALENÍ   |   | <br>E<br>mm | <br>(N) | <br>(N) | Kód zboží    |
|---------------|----------------------|---|---------------|---------|--------------|--|---|--|--|---|--------------|
|               |                      |   |               |         |              | <br>vnitřní | <br>veškovní |  |  |   |              |
| <b>3,2</b>    | <b>8</b>             | 3,40  | 6,50          | 0,80    | 1,80         | 500  | 4.000   | 3,5  | 1000   | 1200  | 01130003208  |
|               | <b>10</b>            |   |               |         |              | 500  | 4.000   | 5,0  |  |   | 01130003210  |
|               | <b>12</b>            |   |               |         |              | 500  | 4.000   | 7,0  |  |   | 01130003212  |
|               | <b>14</b>            |   |               |         |              | 500  | 4.000   | 9,0  |  |   | 01130003214  |
|               | <b>16</b>            |   |               |         |              | 500  | 3.000   | 11,0   |  |   | 01130003216  |
|               | <b>18</b>            |   |               |         |              | 500  | 3.000   | 13,0   |  |   | 01130003218  |
| <b>4,0</b>    | <b>8</b>             | 4,20  | 8,00          | 1,00    | 2,20         | 500  | 4.000   | 4,0  | 1200   | 1400  | 01130004008  |
|               | <b>10</b>            |   |               |         |              | 500  | 4.000   | 6,0  |  |   | 01130004010  |
|               | <b>12</b>            |   |               |         |              | 500  | 3.000   | 8,0  |  |   | 01130004012  |
|               | <b>14</b>            |   |               |         |              | 500  | 3.000   | 10,0   |  |   | 01130004014  |
|               | <b>16</b>            |   |               |         |              | 500  | 3.000   | 12,0   |  |   | 01130004016  |
|               | <b>18</b>            |   |               |         |              | 500  | 3.000   | 14,0   |  |   | 01130004018  |
|               | <b>20</b>            |   |               |         |              | 500  | 3.000   | 16,0   |  |   | 01130004020  |
|               | <b>25</b>            |   |               |         |              | 250  | 1.500   | 21,0   |  |   | 01130004025  |
| <b>4,8</b>    | <b>10</b>            | 5,00  | 9,50          | 1,10    | 2,73         | 500  | 3.000   | 5,0  | 1800   | 2000  | 01130004810  |
|               | <b>12</b>            |   |               |         |              | 500  | 3.000   | 7,0  |  |   | 01130004812  |
|               | <b>14</b>            |   |               |         |              | 250  | 2.000   | 9,0  |  |   | 01130004814  |
|               | <b>16</b>            |   |               |         |              | 250  | 2.000   | 11,0   |  |   | 01130004816  |
|               | <b>18</b>            |   |               |         |              | 250  | 1.500   | 13,0   |  |   | 01130004818  |
|               | <b>21</b>            |   |               |         |              | 250  | 1.500   | 16,0   |  |   | 01130004821  |
|               | <b>24</b>            |   |               |         |              | 200  | 1.200   | 19,0   |  |   | 01130004824  |
|               | <b>27</b>            |   |               |         |              | 200  | 1.200   | 22,0   |  |   | 01130004827  |
|               | <b>30</b>            |   |               |         |              | 200  | 1.200   | 25,0   |  |   | 01130004830  |
|               | <b>32</b>            |   |               |         |              | 200  | 1.200   | 27,0   |  |   | 01130004832  |
|               | <b>35</b>            |   |               |         |              | 150  | 900   | 30,0   |  |   | 01130004835  |
|               | <b>40</b>            |   |               |         |              | 150  | 900   | 32,0   |  |   | 01130004840  |
|               | <b>45</b>            |   |               |         |              | 100  | 600   | 37,0   |  |   | 01130004845  |
|               | <b>50</b>            |   |               |         |              | 100  | 600   | 42,0   |  |   | 01130004850  |
|               | <b>5,0*</b>          | <b>40</b>   | 5,20          | 9,30    | 1,50         | 2,73   | 150   | 900  | 32,0   | 2000  | 2100         |
| <b>45</b>     |                      |   |               |         |              | 100  | 600   | 37,0   |  |   | 01130005045  |
| <b>50</b>     |                      |   |               |         |              | 100  | 600   | 42,0   |  |   | 01130005050  |
| <b>55</b>     |                      |   |               |         |              | 100  | 600   | 47,0   |  |   | 01130005055  |
| <b>60</b>     |                      |   |               |         |              | 500  |   | 52,0   |  |   | 01130005060  |
| <b>65</b>     |                      |   |               |         |              | 500  |   | 57,0   |  |   | 01130005065  |
| <b>70</b>     |                      |   |               |         |              | 500  |   | 62,0   |  |   | 01130005070  |
| <b>75</b>     |                      |   |               |         |              | 500  |   | 68,0   |  |   | 01130005075  |
| <b>80</b>     |                      |   |               |         |              | 500  |   | 72,0   |  |   | 01130005080  |
| <b>90</b>     |                      |   |               |         |              | 500  |   | 80,0   |  |   | 01130005090  |
| <b>100</b>    |                      |   |               |         |              | 500  |   | 90,0   |  |   | 01130005100  |
| <b>110</b>    |                      |   |               |         |              | 500  | 100,0   |  |  |   | 011300050110 |
| <b>120</b>    |                      |   |               |         |              | 500  | 110,0   |  |  |   | 011300050120 |
| <b>130</b>    |                      |   |               |         |              | 250  | 120,0   |  |  |   | 011300050130 |
| <b>140</b>    |                      |   |               |         |              | 250  | 130,0   |  |  |   | 011300050140 |
| <b>150</b>    |                      |   |               |         |              | 250  | 140,0   |  |  |   | 011300050150 |
| <b>160</b>    |                      |   |               |         |              | 250  | 150,0   |  |  |   | 011300050160 |
| <b>170</b>    |                      |   |               |         |              | 250  | 160,0   |  |  |   | 011300050170 |
| <b>180</b>    |                      |   |               |         | 250          | 170,0  |   |  |  | 011300050180  |              |
| <b>190</b>    |                      |   |               |         | 250          | 180,0  |   |  |  | 011300050190  |              |
| <b>6,4*</b>   | <b>35</b>            | 6,60  | 13,00         | 2,00    | 3,50         | 100  | 600   | 25,0   | 2450   | 3500  | 01130006435  |
|               | <b>50</b>            |   |               |         |              | 500  |   | 40,0   |  |   | 01130006450  |
|               | <b>75</b>            |   |               |         |              | 500  |   | 65,0   |  |   | 01130006475  |
|               | <b>80</b>            |   |               |         |              | 250  |   | 70,0   |  |   | 01130006480  |
|               | <b>100</b>           |   |               |         |              | 250  |   | 90,0   |  |   | 011300064100 |
|               | <b>120</b>           |   |               |         |              | 250  |   | 110,0  |  |   | 011300064120 |
|               | <b>125</b>           |   |               |         |              | 250  |   | 115,0  |  |   | 011300064125 |
|               | <b>150</b>           |   |               |         |              | 250  |   | 140,0  |  |   | 011300064150 |
|               | <b>175</b>           |   |               |         |              | 200  |   | 165,0  |  |   | 011300064175 |
|               | <b>190</b>           |   |               |         |              | 200  |   | 180,0  |  |   | 011300064200 |

\*Pozn: Slupkové nýty s hliníkovým tělem Al Mg3.