

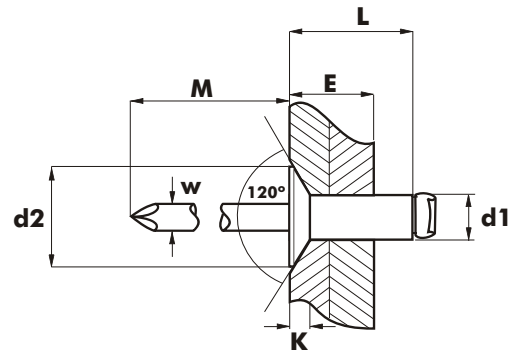

# STAINLESS STEEL A2 COUNTERSUNK HEAD 120°

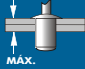



**BODY: Stainless Steel 304**  
**MANDREL: Stainless Steel 304**

UNE - EN ISO 15984

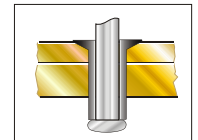
d1 Ø m/m	L m/m	d2 Ø m/m	K m/m	W Ø m/m	M MÍN. m/m	I m/m	 MAX. E m/m		COD.
<b>3,2</b>	<b>6</b>	<b>6,0</b>	0,90	2,10	30,0			3,30	01270 00 3206
	<b>8</b>								01270 00 3208
	<b>10</b>								01270 00 3210
	<b>12</b>								01270 00 3212



d1 Ø m/m	 (N)	 (N)
<b>3,2</b>	2.500	2.750

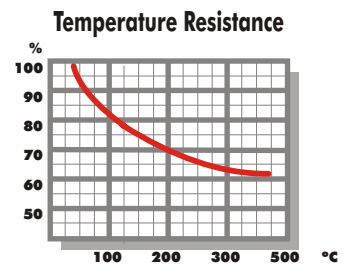

**RAL**

More sizes 



# STAINLESS STEEL A2 COUNTERSUNK HEAD 120°



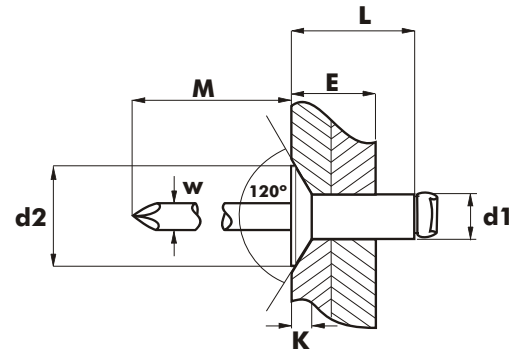

**BODY: Stainless Steel 304**  
**MANDREL: Stainless Steel 304**

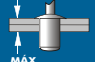

UNE - EN ISO 15984

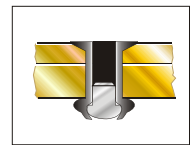
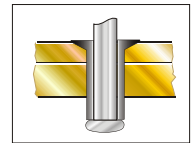
d1 Ø m/m	L m/m	d2 Ø m/m	K m/m	W Ø m/m	M MIN. m/m	I m/m	 MAX. E m/m		COD.
<b>4,0</b>	<b>8</b>	<b>7,5</b>	1,00	2,40	30,0	9,60	3,0 - 5,0	4,10	01270 00 4008
	<b>10</b>				11,60	5,0 - 6,5	01270 00 4010		
	<b>12</b>				13,60	6,5 - 8,5	01270 00 4012		
	<b>14</b>				15,60	8,5 - 10,5	01270 00 4014		
<b>4,8</b>	<b>8</b>	<b>9,0</b>	1,20	3,10	30,0	10,00	3,0 - 4,5	4,90	01270 00 4808
	<b>10</b>				12,00	4,5 - 6,0	01270 00 4810		
	<b>12</b>				14,00	6,0 - 8,0	01270 00 4812		
	<b>14</b>				16,00	8,0 - 10,0	01270 00 4814		

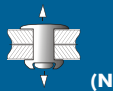

d1 Ø m/m	 (N)	 (N)
<b>4,0</b>	3.500	4.000
<b>4,8</b>	4.500	5.500

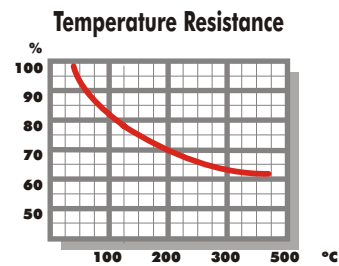

**RAL**

More sizes 